

# Base R-80

Unlock more insights and guidance through our media resources:



[www.buchi.com/r-80/service](http://www.buchi.com/r-80/service)



## NOTE

Reading and following the instructions in this document does not replace reading and following the instructions in the operation manual.

- ▶ This operation must be performed by qualified, authorized and trained technicians, consistent with the local applicable regulations.
- ▶ Only carry out the service described in this section.
- ▶ Use only genuine BUCHI spare parts in order to ensure correct operation and preserve the warranty.
- ▶ Carry out the service described in this section to extend the lifetime of the instrument.

## Base R-80

	Order no.	Image
Base R-80 100 – 120 V, complete	11080626	
Base R-80 220 – 240 V, complete	11080627	

## Tools

	Order no.	Image
Torx size 10	none	
Torx size 20	none	

## Replacing the Base R-80



## CAUTION

### Electrical voltage at conductive parts

Risk of electric shock

- ▶ Observe general safety regulations when handling electrical equipment.
- ▶ Work on electrical equipment must be performed by authorized and qualified personnel.
- ▶ Disconnect the power plug before opening the instrument.
- ▶ Do not touch any live parts.



## CAUTION

### ESD protective area

Damage to sensitive components

- ▶ Use electrostatic discharged protective procedures.
- ▶ Make sure you are properly grounded before touching any internal materials.

Precondition:

- Instrument is disconnected from the main supply.

- ▶ Remove all connections.
- ▶ Remove all accessories.
- ▶ Remove all glass parts.
- ▶ Remove the heating bath.
- ▶ Move the rotary drive arm in base position. (All the way up.)

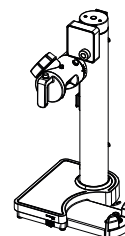

- ▶ Hold the height adjustment stopper as shown in the graphic.
- ▶ Remove the height adjustment stopper through the notch in the toothed rack.

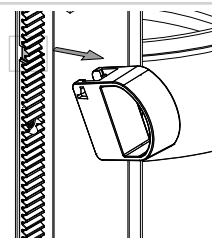

- ▶ Remove the lower cable and tubing fixture.

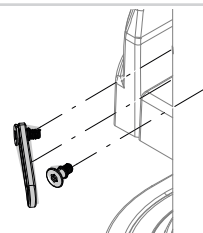

- ▶ Lay the instrument horizontally on a table.
- ▶ Remove the screws with the marked arrow.

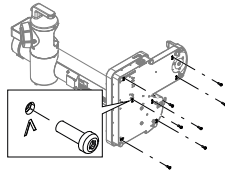

**NOTICE! The base plate weights inside the Rotavapor® could fall out. Keep the base plate cover in position.**

- ▶ Pull out the instrument base.
- ▶ Remove the screw.

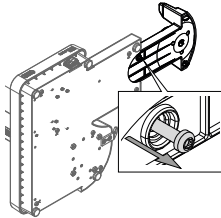

- ▶ Position and tighten the screw to fix the instrument base from moving around.

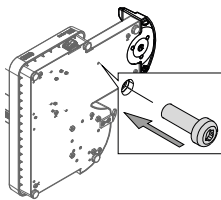

- ▶ Hold the base plate and place the instrument back in the upright position.
- ▶ Move the rubber gasket fully up.

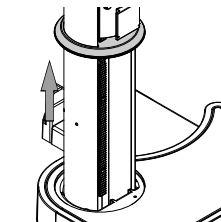

- ▶ Lift the base cover fully up.

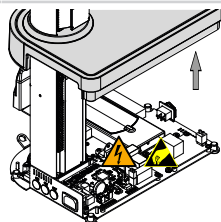

- ▶ Hold the height adjustment stopper as shown in the graphic.
- ▶ Install the height adjustment stopper through the notch in the toothed rack.

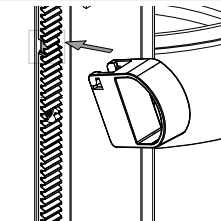

- ▶ Secure the base cover with the height adjustment stopper.

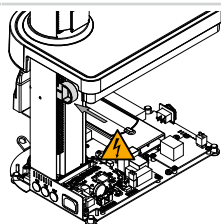

- ▶ Remove and put aside the two weights on the base plate.

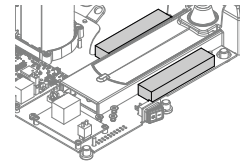

- ▶ Remove the two ribbon cables.

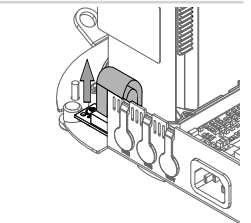

- ▶ Remove the four screws of the tower.

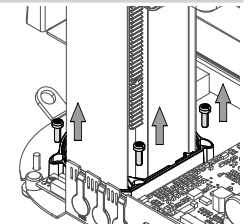

- ▶ Remove the tower.

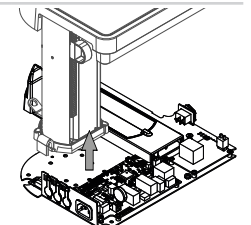

- ▶ Remove the damaged base plate.
- ▶ Dispose the base plate. See "Operation Manual Rotavapor® R-80".

- ▶ Position the tower on the new base plate.

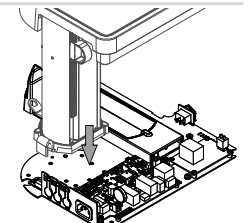

- ▶ Position and tighten the four screws of the tower.

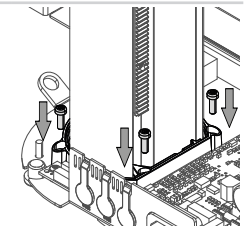

- ▶ Attach the two ribbon cables.

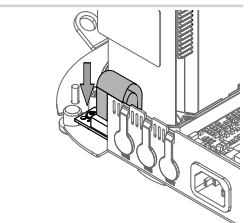

- ▶ Reposition the two weights on the base plate.

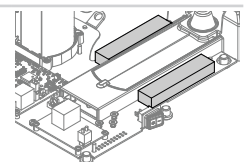

- ▶ Hold the height adjustment stopper as shown in the graphic.
- ▶ Remove the height adjustment stopper through the notch in the toothed rack.

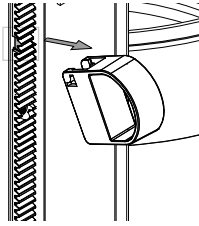

- ▶ Move the base cover back on the base plate.

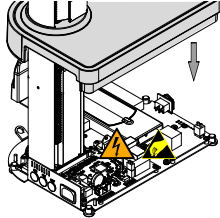

- ▶ Move the rubber gasket into position.

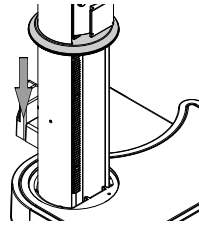

- ▶ Hold the base plate and lay the instrument horizontally on a table.
- ▶ Position and tighten the screws.

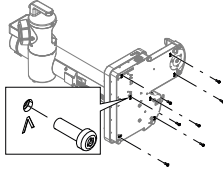

- ▶ Remove the screw on the instrument base.

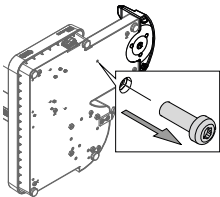

- ▶ Position and tighten the screw of the instrument base.
- ▶ Push the instrument base back in.

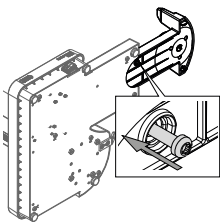

- ▶ Place the instrument back in the upright position.
- ▶ Attach the cable and tubing fixture.

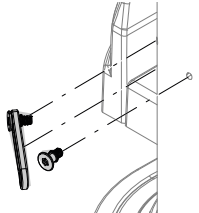

- ▶ Hold the height adjustment stopper as shown in the graphic.
- ▶ Install the height adjustment stopper through the notch in the toothed rack.

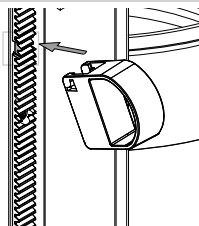

- ▶ Check that all functions of the instrument are working properly.
- ▶ Prepare the instrument. See additional chapter according to the delivered components.