

# Interface R-180

Unlock more insights and guidance through our media resources:



[www.buchi.com/r-180/installation](http://www.buchi.com/r-180/installation)



### NOTE

Reading and following the instructions in this document does not replace reading and following the instructions in the operation manual.

- ▶ This operation must be performed by qualified, authorized and trained technicians, consistent with the local applicable regulations.
- ▶ Only carry out the service described in this section.
- ▶ Use only genuine BUCHI spare parts in order to ensure correct operation and preserve the warranty.
- ▶ Carry out the service described in this section to extend the lifetime of the instrument.

## Interface R-180

	Order no.	Image
Interface R-80 / R-180, complete	11080629	

## Tools

	Order no.	Image
Torx size 10	none	

## Replacing the interface

Precondition:

- ☒ Instrument is disconnected from the main supply.

- ▶ Remove all connections.
- ▶ Remove all accessories.
- ▶ Remove all glass parts.
- ▶ Remove the heating bath.

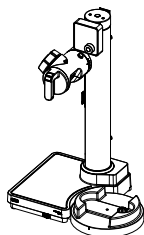

- ▶ Remove the four screws.

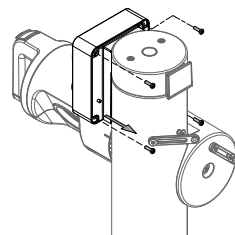

- ▶ Carefully open the interface housing.

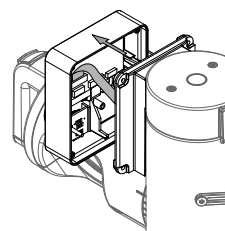

- ▶ Open the ribbon connector with the finger.

**NOTICE! Do not use a screwdriver to open ribbon connectors. It can damage the pins and the ribbon cable.**

- ▶ Gently remove the ribbon cable.

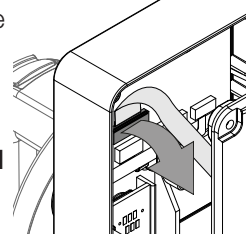

- ▶ Remove the damaged interface.

- ▶ Keep the sealing.

- ▶ Dispose the interface. See "Operation Manual Rotavapor® R-180".

- ▶ Reposition the sealing.

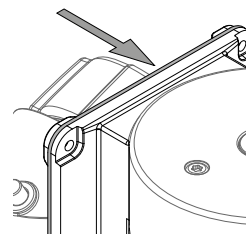

- ▶ Take the new interface.

- ▶ Carefully guide the ribbon cable into the ribbon connector.

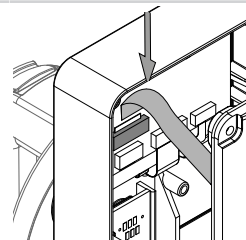

- ▶ Close the ribbon connector with the finger.

**NOTICE! Do not use a screwdriver to close ribbon connectors. It can damage the pins and the ribbon cable.**

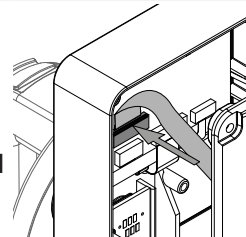

- Position the interface housing.
- Slightly shake the interface housing that the sealing remains in position and to avoid sealing damage.

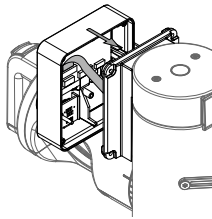

- Position and tighten the four screws.

