

## Replacement Guide

# Gas spring R-180

Unlock more insights and guidance through our media resources:



[www.buchi.com/r-180/installation](http://www.buchi.com/r-180/installation)



### NOTE

Reading and following the instructions in this document does not replace reading and following the instructions in the operation manual.

- ▶ This operation must be performed by qualified, authorized and trained technicians, consistent with the local applicable regulations.
- ▶ Only carry out the service described in this section.
- ▶ Use only genuine BUCHI spare parts in order to ensure correct operation and preserve the warranty.
- ▶ Carry out the service described in this section to extend the lifetime of the instrument.

## Gas spring R-180

	Order no.	Image
Gas spring, complete	11083854	

## Tools

	Order no.	Image
Torx size 20	none	

## Replacing the gas spring

Precondition:

- ☒ Instrument is connected to the main supply.

- ▶ Remove all connections other than the main supply.
- ▶ Remove all accessories.
- ▶ Remove all glass parts.
- ▶ Remove the heating bath.

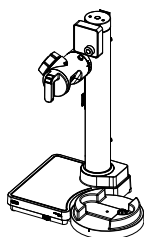

- ▶ Switch on the instrument.
- ▶ Move the rotary drive arm to its middle position.

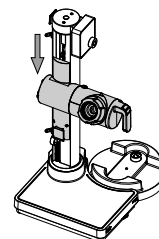

- ▶ Lay the instrument on a table.
- ▶ Place a box underneath the upper part of the tower so that the tower is horizontal.

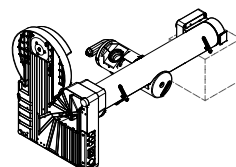

- ▶ **NOTICE! The gas spring can pop out due to the counterpressure.**

Remove the two screws.

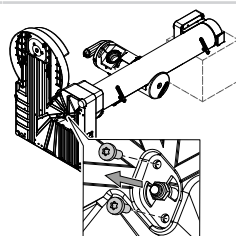

- ▶ Pull out the gas spring.

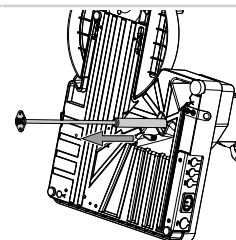

- ▶ Pay attention to the orientation of the gas spring's top end.
- ▶ Place the gas spring aside.

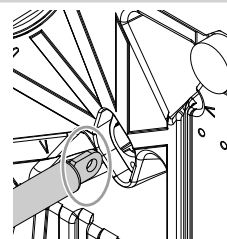

- ▶ Dispose the gas spring. See "Operation Manual Rotavapor® R-180".

- ▶ Position the new gas spring with its top end in the same orientation as the removed gas spring.

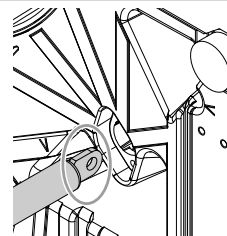

BÜCHI Labortechnik AG  
Meierseggestrasse 40  
9230 Flawil  
E-Mail: [quality@buchi.com](mailto:quality@buchi.com)

11594790A en  
Gas spring R-180  
09.2025



- ▶ Insert the new gas spring carefully, while moving the rotary drive arm upwards.

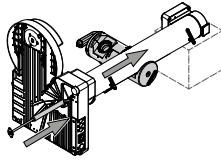

- ▶ Tighten the two screws.

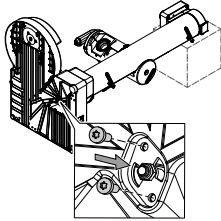

- ▶ Place the instrument back in the upright position.
- ▶ To check proper function, move the rotary drive arm to its highest and lowest positions.

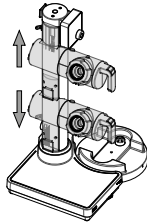

- ▶ Check that all functions of the instrument are working properly.
- ▶ Prepare the instrument. See additional chapter according to the delivered components.