

Rotary drive arm R-180

Unlock more insights and guidance through our media resources:



www.buchi.com/r-180/installation



NOTE

Reading and following the instructions in this document does not replace reading and following the instructions in the operation manual.

- ▶ This operation must be performed by qualified, authorized and trained technicians, consistent with the local applicable regulations.
- ▶ Only carry out the service described in this section.
- ▶ Use only genuine BUCHI spare parts in order to ensure correct operation and preserve the warranty.
- ▶ Carry out the service described in this section to extend the lifetime of the instrument.

Rotary drive arm R-180

	Order no.	Image
Rotary drive arm R-180, complete	11082708	

Tools

	Order no.	Image
Torx size 20	none	

Replacing the rotary drive arm

Precondition:

- ☒ Instrument is disconnected from the main supply.

- ▶ Remove all connections.
- ▶ Remove all accessories.
- ▶ Remove all glass parts.
- ▶ Remove the heating bath.

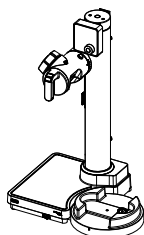

- ▶ Remove the screw, washer and sealing.

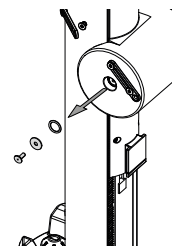

- ▶ Push the angle adjustment button and release the rotary drive arm.

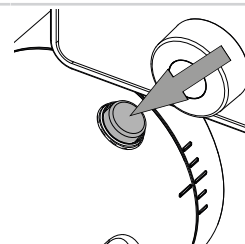

- ▶ Pull the rotary drive arm until the ribbon cable is visible.

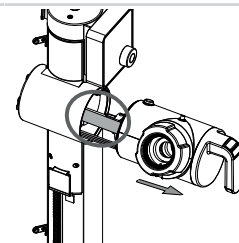

- ▶ Gently remove the ribbon cable from the connector.

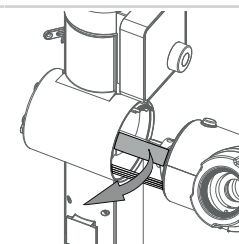

- ▶ Slowly pull the rotary drive arm until the cable is accessible.
- ▶ Disconnect the cable.

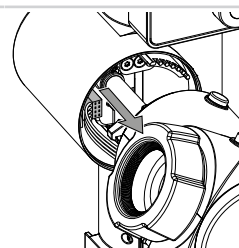

- ▶ Remove the rotary drive arm and set it aside.

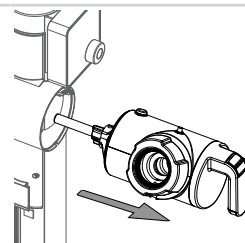

- ▶ Dispose the rotary drive arm. See "Operation Manual Rotavapor® R-180".



- Gently guide the rotary drive arm axis in place.

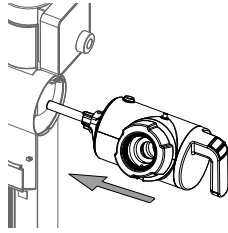

- Connect the cable.
- Slide in the rotary drive arm slightly.

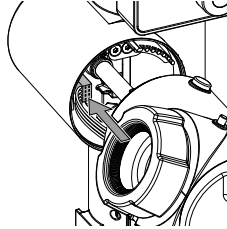

- Connect the ribbon cable carefully.

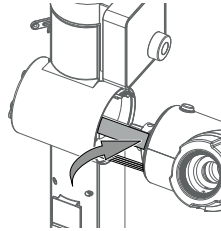

- Position the rotary drive arm.

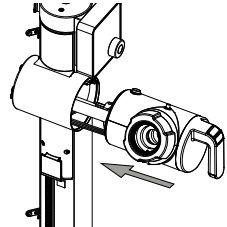

- Push the angle adjustment button and secure the rotary drive arm.

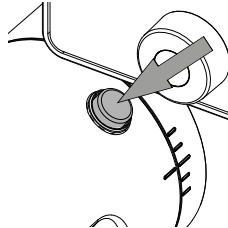

- Position the sealing and the washer.
- Position and tighten the screw.

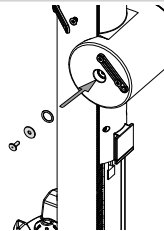

- Check that all functions of the instrument are working properly.
- Prepare the instrument. See additional chapter according to the delivered components.