

# Base R-180

Unlock more insights and guidance through our media resources:



[www.buchi.com/r-180/installation](http://www.buchi.com/r-180/installation)



## NOTE

Reading and following the instructions in this document does not replace reading and following the instructions in the operation manual.

- ▶ This operation must be performed by qualified, authorized and trained technicians, consistent with the local applicable regulations.
- ▶ Only carry out the service described in this section.
- ▶ Use only genuine BUCHI spare parts in order to ensure correct operation and preserve the warranty.
- ▶ Carry out the service described in this section to extend the lifetime of the instrument.

## Base R-180

	Order no.	Image
Base R-180 100–120 V, complete	11084922	
Base R-180 200–240 V, complete	11084923	

## Tools

	Order no.	Image
Torx size 10	none	
Torx size 20	none	

## Replacing the base



## CAUTION

### Electrical voltage at conductive parts

Risk of electric shock

- ▶ Observe general safety regulations when handling electrical equipment.
- ▶ Work on electrical equipment must be performed by authorized and qualified personnel.
- ▶ Disconnect the power plug before opening the instrument.
- ▶ Do not touch any live parts.



## CAUTION

### ESD protective area

Damage to sensitive components

- ▶ Use electrostatic discharged protective procedures.
- ▶ Make sure you are properly grounded before touching any internal materials.

Precondition:

- ☒ Instrument is disconnected from the main supply.

- ▶ Remove all connections.
- ▶ Remove all accessories.
- ▶ Remove all glass parts.
- ▶ Remove the heating bath.

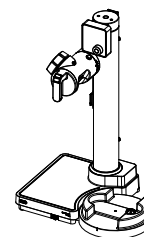

- ▶ Pull out the bath base until the cover edge is visible.

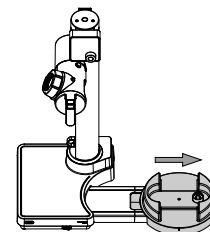

- ▶ Remove the lower cable and tubing fixture.

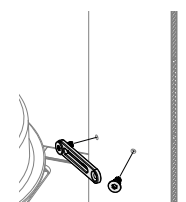

- Move the height adjustment stopper to its highest position.
- Move up the rubber sealing.

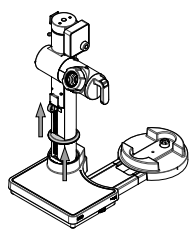

- Lay the instrument horizontally on a table.
- Remove the screws with the marked arrow.

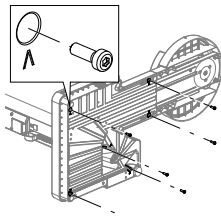

- Hold the base plate and place the instrument back in the upright position.
- Lift the base cover fully up.

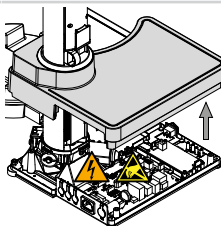

- Secure the base cover with another screw driver.

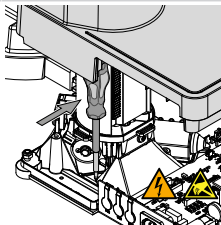

- Disconnect the three ribbon cables.

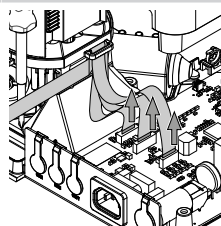

- Disconnect the motor cables.

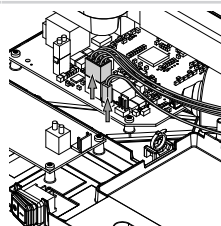

- Carefully remove the cables from the cable guide, noting the cable positions.

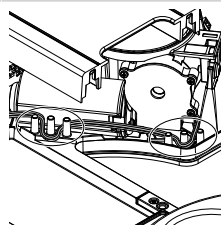

- Loosen the tower screws by one full turn.

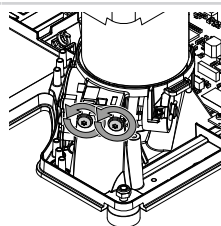

- Loosen the tower screw under the ribbon cable by one full turn.

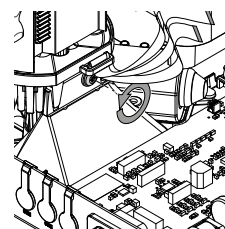

- Remove the tower and place it aside.

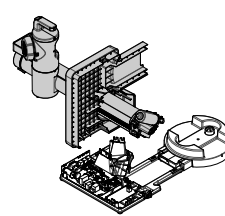

- Remove the damaged base plate.
- Dispose the base plate. See "Operation Manual Rotavapor® R-180".

- Set the tower on the new base plate.
- Tighten the screw under the ribbon cable.

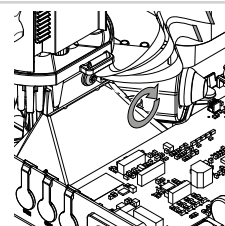

- Tighten the tower screws.

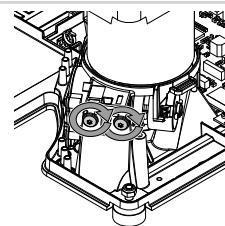

- Place the cables into the cable guide.

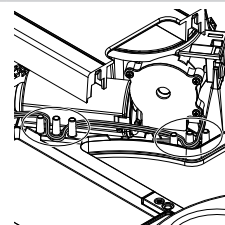

- Connect the motor cables.

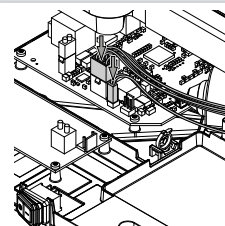

- Connect the ribbon cables.

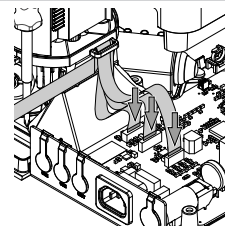

- Move the base cover back on the base plate.

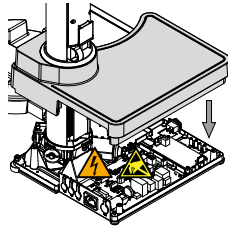

- Move the height adjustment stopper and rubber sealing down.

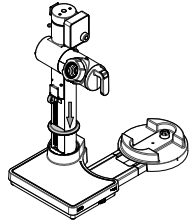

- Hold the base plate and lay the instrument horizontally on a table.
- Position and tighten the screws.

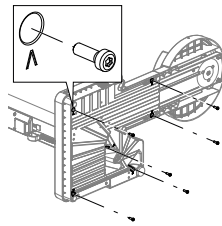

- Place the instrument back in the upright position.
- Reassemble the lower cable and tubing fixture.

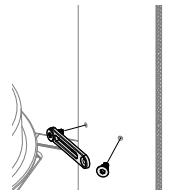

- Push the bath base back in position.

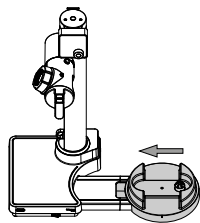

- Check that all functions of the instrument are working properly.
- Prepare the instrument. See additional chapter according to the delivered components.